

Fill 92 ^{Bowie Co.} 50
16
Wm. C. T. Clark

absq. 659
James Chapman

— 1380 Ams —
v. 72

Correct on map of Bowie Co.
May. 9/48. Greurbaur.
H. webd. ptd.

Cart for planting in
Bowie District
original
Crosby

Patented May 13th 1848
Elgin.

v. 226 vol 2

Contents
142 Certs
3 - F. N.

misc 2465.
make printed

Republic of Texas
County of Red River

This is to certify that James Watson
appeared before the board of land commissioners
of the county aforesaid and proved according
to the laws of this Republic of subse-
quent to the declaration of Independence
1836 - and that he is a married man
is entitled to Twelve hundred
acres of land to be surveyed after the first
of August 1838. Given under our hands
at Springfield this 5th day of July 1838.

[Faint, illegible handwritten notes on the left margin]

M^y M^r Matthew P. B. S. C
James Latimer
David Law

[Vertical signature on the right margin]

B. Goshall W^m

[Faint, illegible handwritten notes at the bottom of the page]

Res. File 92
Am. Co. of Clk

Cond. Certificate

James Watson

1280 Amd

James Watson

James Watson

James Watson
1280 Amd

N.B.

James Watson

Appropriated by
Survey of Lowell
Mass. & Co. of Clk
acres 1280
N.B.
James Watson

Republic of Texas }
County of Bowie }

No 725
2nd Clap.

James Watson is entitled to 1280 — Acres of

of Land by virtue of certificate No 35 dated 5. July 1838.
granted to him by the Board of Land Commissioners
for the County of Red River. He having proved ~~that~~ ^{to us that}
he has resided in the Republic three years and performed all
the duties required of him as a citizen.

Attest.

L. M. Rice. Clerk of
County Court. By
J. Benton Jr. Supt. Clk.
& ex off Clk. Bd
Land Commrs.

Given, under our hand and the
Seal of the County of Boston the 7th day of July 1842.
J. M. Smith Chief Justice
and we as Just. Board Land Com. County

Mapark, G. Larver

1842
J. M. Smith

File 92 (2)
P. K. King
D. W. C. D. Club

Uncond. Certificate
James Watson
1880 Club

Pro 79.
D. W. C. D. Club
James Watson

N D.L.

Scale of 4000 W per Inch & One Degree Variation

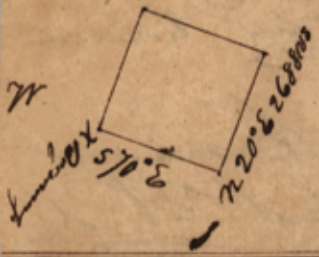

Republic of Texas Surveyed for James Watson
 Red River County Twelve Hundred & Eighty
 acres of Land the quantity to which he is entitled
 By virtue of Cert. No. 35 issued to him by the
 board of Land Commissioners for Red River

County dated the 5th day of July 1838 Situated North of Sulphur
 Fork ^{near Exposition Ferry} ^{near Sulphur Fork} Beginning at the S. E. Corner of a survey made
 in the name of Mark Epperson standing in the bottom of Sulphur
 Fork from which a Hackberry marked X bears N. 42° 30' W
 82 1/2 vrs an Elm marked X bears N. 48° 30' W 2 1/2 vrs
 South 20° West 400 vrs to a stake from which an Elm
 marked X bears N 35° 30' E 7.6 vrs an over cup Oak marked
 J. W. bears N. 46° E 3 vrs Thence South 70° E 2688 vrs to
 a stake from which an over cup marked J. W. bears West
 3.5 vrs a Hackberry marked X bears N 54° W 5 1/2 vrs
 Thence North 20° E 2688 vrs to a stake from which a Post
 Oak marked J. W. bears S. 63° 30' W 19 vrs Thence North 77° W
 2688 vrs to a stake from which a willow oak marked J. W. bears
 S. 140° W another Willow oak J. W. S. 17° 20' W 16 vrs Thence
 South 20° W. 288 vrs to the North East Corner of ^{Epperson's} ^{Survey}
 from which a ~~Post Oak marked X bears N 72° W 35 vrs~~
~~Black oak S 44° W 11 vrs Thence South 20° W 2688 vrs~~
 E. boundary of R. Survey to the Beginning Survey 1st Sept 1838

By J. Bass } Chain }
 Geo. Wright }
 West } Corners }

W. S. McClure

I do solemnly Declare under oath in my office that the survey
 presented by the foregoing plat & field notes was made accord
 ing to law & since the 4th of Aug 1838 & that the limits boundaries
 & corners with its shores natural & artificial are there
 in truly described 2nd Sept. 1838 W. S. McClure

I do certify that I have examined the foregoing field notes and find them correct and made according to law at Blacksburg Oct-31st-1840.

A. J. Harmon
C. S. P. R. C.

Page No. 92
Examined by J. J. [unclear]

Field notes, Blacksburg
Harmon & [unclear]

Examined by
19th 1840

No. 249
2nd Class

James Watson
plat of field notes

1280 Acres
DL

Examined &
Recorded Oct
31st-1840

A. J. Harmon
C. S. P. R. C.

Harmon